

CarPlay decoder

# User Manual

for HMI 2.0 & HMI 2.5 System

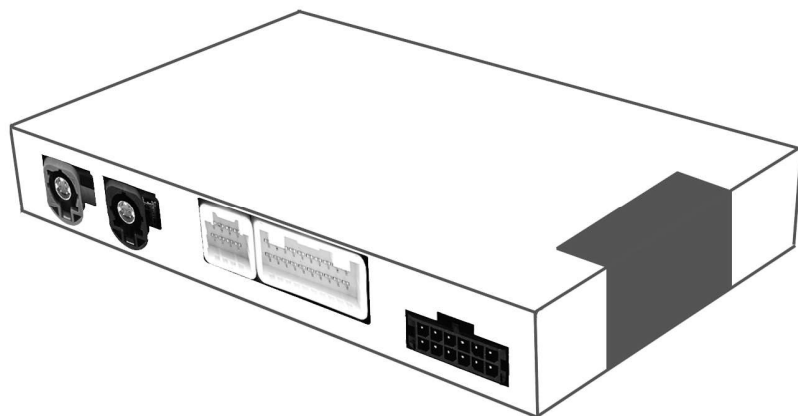

# Contents

1. Dashboard Removal.....	1
2. Toggle Switch Setup.....	1
3. Cables Connection.....	2
3.1 Product accessories.....	2
3.2 Cable connection chart.....	2
3.3 Power cable connection .....	3
3.4 LVDS cable connection.....	5
3.5 System switching .....	4
3.6 Where to put the CarPlay box .....	5
3.5 Mic installation .....	6
4. Sound Setup.....	6
5. Reverse Camera Camera cable connection .....	10
5.1 Original camera setting.....	10
5.2 Aftermarket rear camera .....	10
6. CarPlay and Android Auto.....	11
6.1 Wireless CarPlay / Android Auto.....	11
6.2 Wired CarPlay / Android Auto.....	11
7. Air Play and Mirror Link.....	12
7.1 Wireless Air Play.....	12
7.2 Wireless Android Mirroring .....	13
8. Contact Us.....	14
9. FAQ .....	14

## 1. Dashboard Removal

Please scan QR code, view the detail via YouTube video on dashboard removal guidance.



## 2. Toggle Switch Setup

1) Where is the toggle switch?

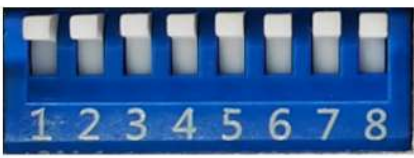
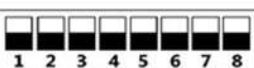

2) Dial code setup

dial setup 1		Smart Link System									
		OFF ON ↓									
				1	2	3	4	5	6	7	8
				off	✓	✓	✓	✓	✓	✓	✓
				on							

Notice: if the car has original OEM camera, the status of code NO.1 shall be "on".

## 3. Cables Connection

### 3.1 Product accessories

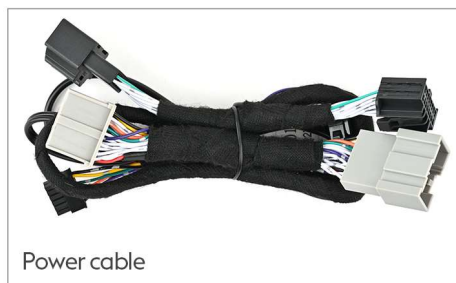

Power cable



LvDs cable 1



RCA cable



External Mic



LvDs cable 2

### 3.2 Cable connection chart

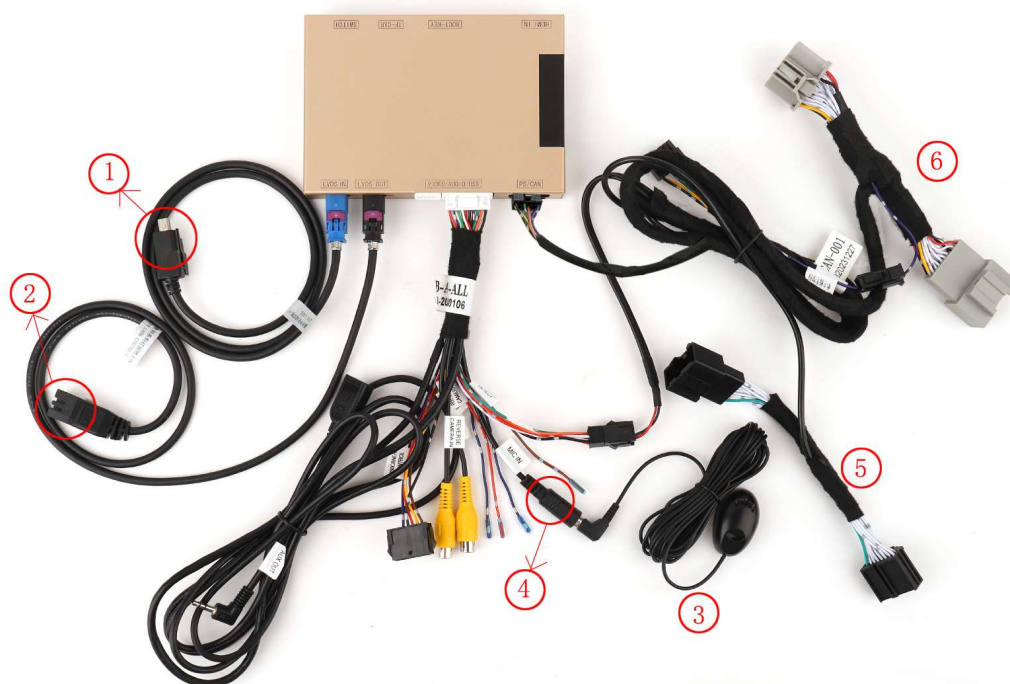

- ① LVDS IN cable: goes to the LVDS port of HMI module
- ② LVDS OUT cable: goes to the original LVDS cable
- ③ External MIC, connect to ④ MIC-IN
- ④ MIC-IN
- ⑤ New power cable, connect to HMI module and HMI power cable
- ⑥ New power cable: connect to Radio control module and Radio power cable

### 3.3 Power cables connection

#### HMI module cable connection

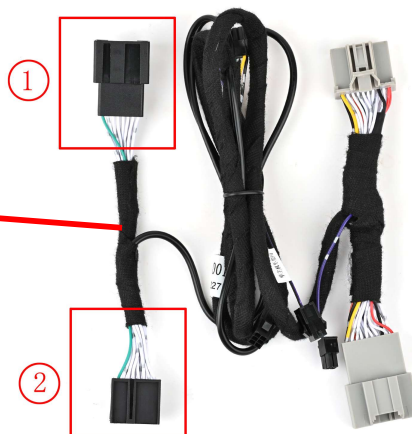
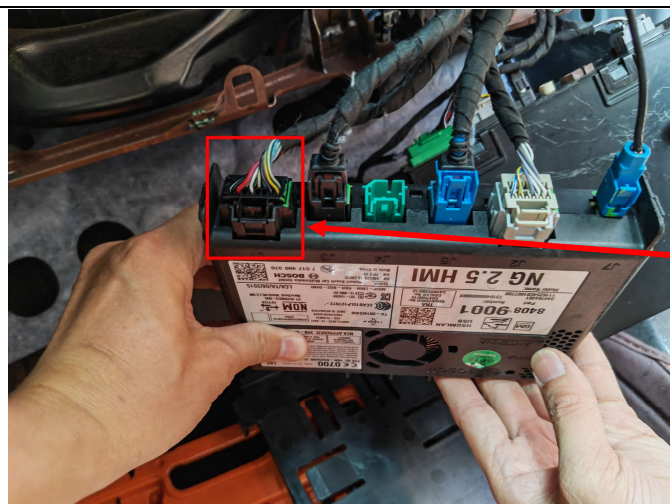

① connect to HMI power cable

② connect to HMI power port

#### Radio control module cable connection

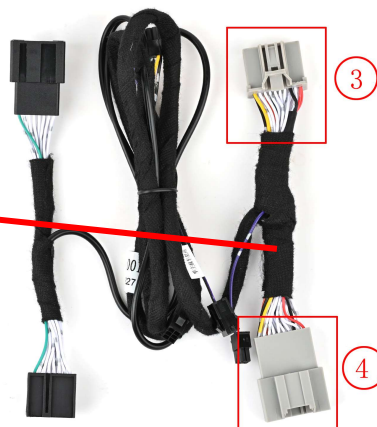
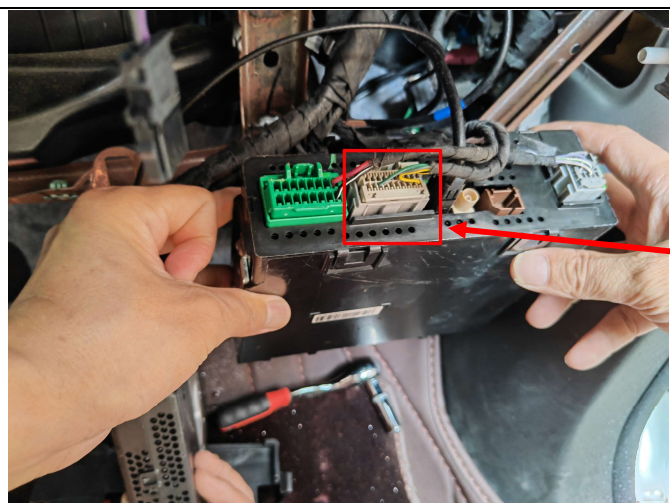

③ connect to Radio module power port

④ connect to Radio module power cable



Note:



### 3.4 LVDS cable connection

#### LVDS cable connection

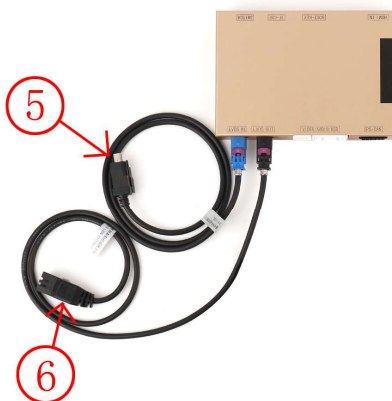
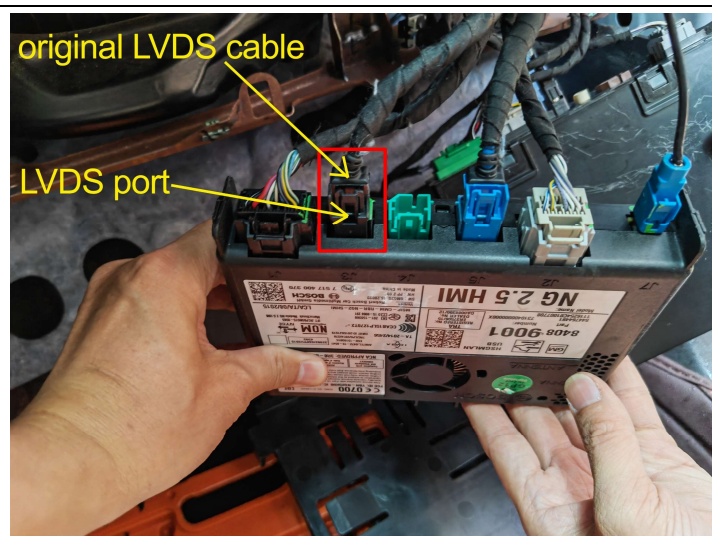

- ⑤ LVDS IN, goes to LVDS port of HMI module (J3 port)
- ⑥ LVDS OUT, goes to original LVDS cable

### 3.5 System switching

After power cables and LVDS cables connection done, by long press "HOME" button, you can switch the system between the original system and the CarPlay system.

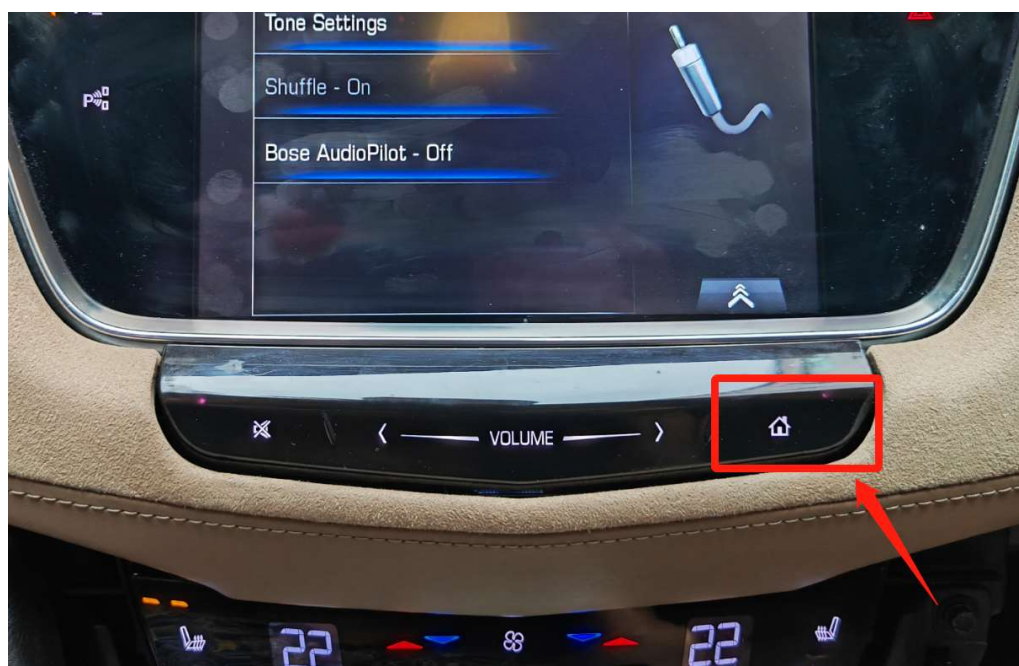

### 3.6 Where to put the CarPlay box

CarPlay decoder box can be installed inside the Storage box in front of passenger, or come other suitable locations.

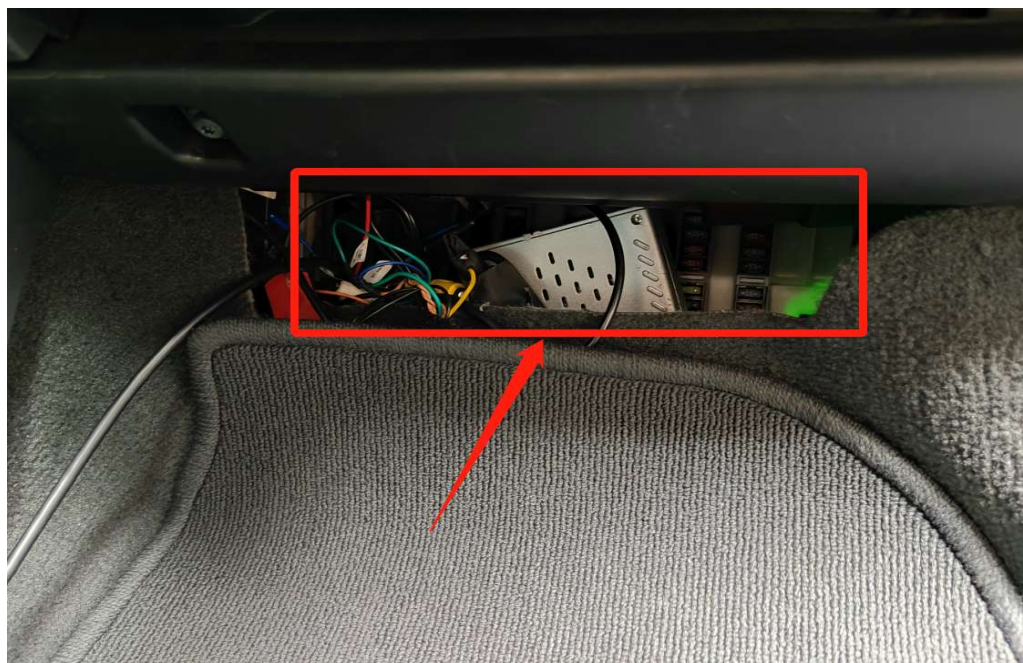

### 3.7 Mic installation

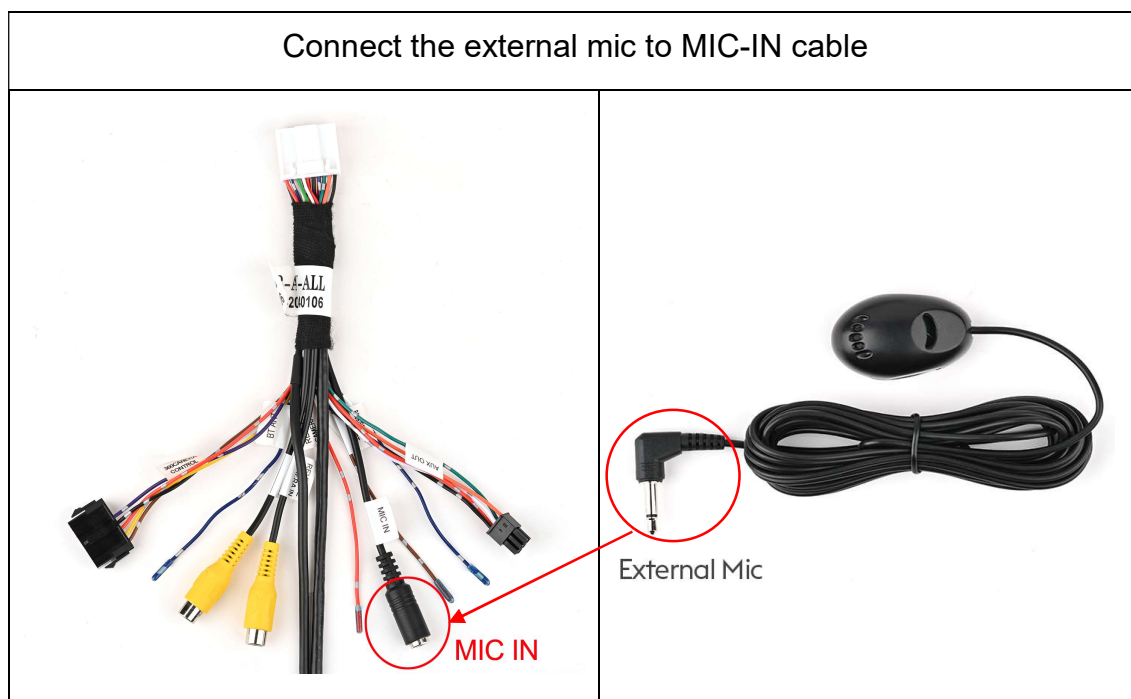

Below is the example of Mic installation and cable laying, just take it as reference.

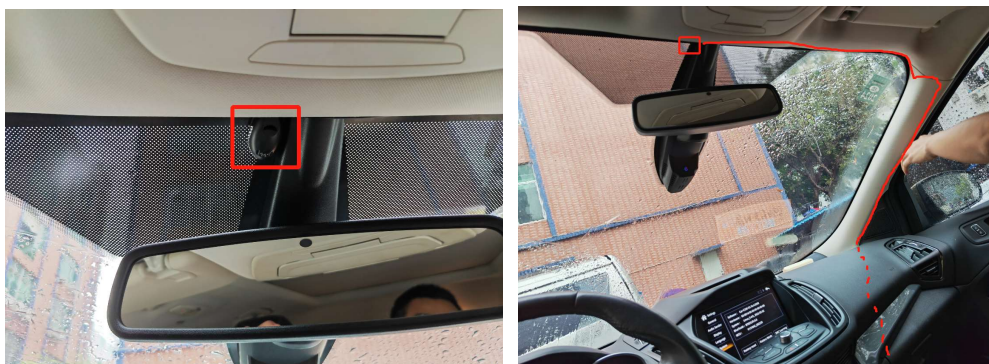

## 4. Sound Setup

Three ways optional for sound transmission to car audio.

### 4.1 AUX sound transmission

4.1.1 Disconnect the Bluetooth between your phone and your car.

4.1.2 Connect the AUX-OUT cable.



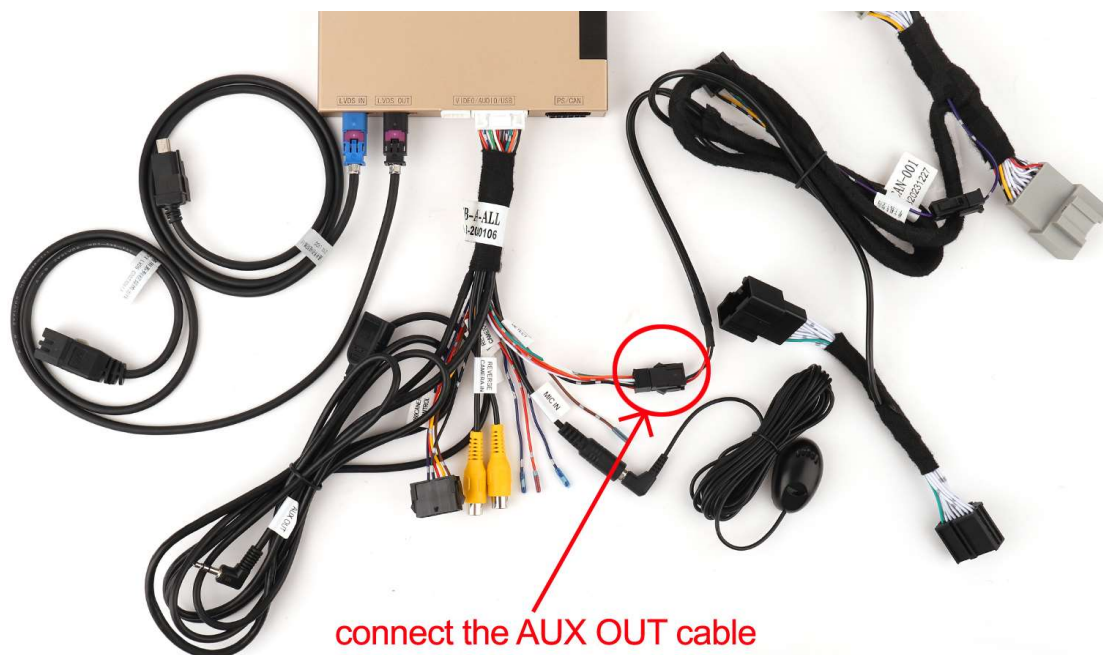

#### 4.1.3 Connect the AUX cable to your car AUX jack

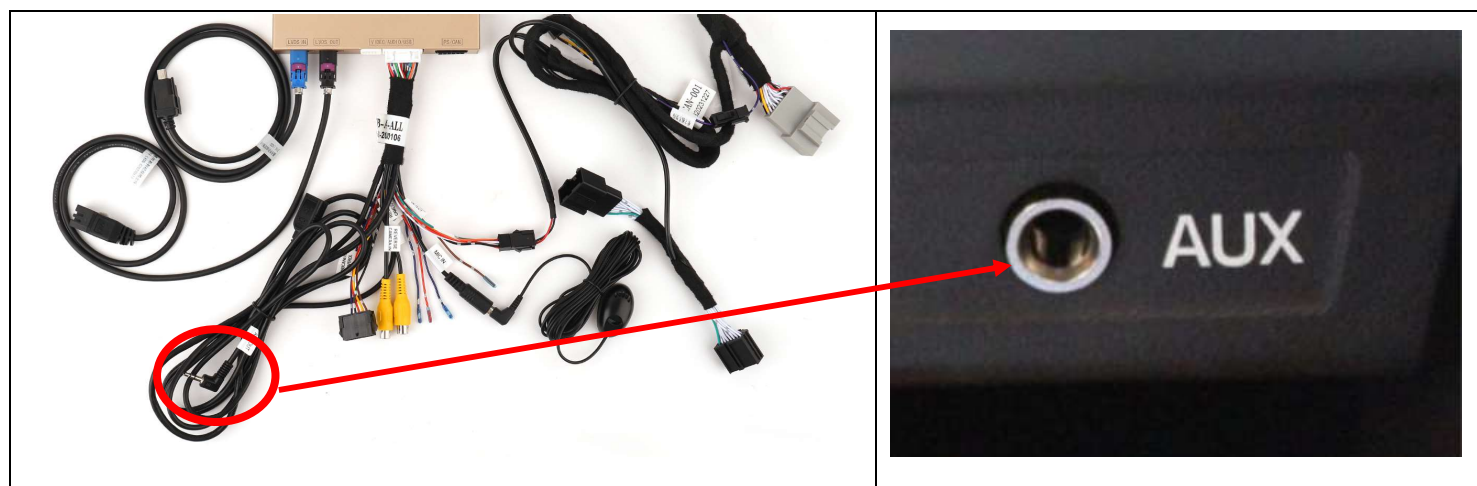

#### 4.1.4 AUX setup

Before using the CarPlay system, you need to set the sound input on your OEM interface to "AUX", then long press 'HOME' button to switch into the CarPlay system and enjoy the CarPlay.



## 4.2 Bluetooth transmission

Note: Bluetooth transmission output not for all the cars, some car models may have Bluetooth compatibility issues.

4.2.1 In the original car system, search for BT-Transmitter \* \* devices and pair

4.2.2 Before using the CarPlay system, you need to set the sound input on your OEM interface to "Bluetooth", then long press 'HOME" button to switch into the CarPlay system and enjoy the CarPlay.



### 4.3 Phone Bluetooth

Note: This sound connection mode only supports Carplay and Android Auto, as well as Bluetooth calls. USB/SD card music video sound output is not supported. Mirrored sound output is not supported.

#### 4.3.1 Turn on Setup—System, set the Use Car's BT channel to "ON"

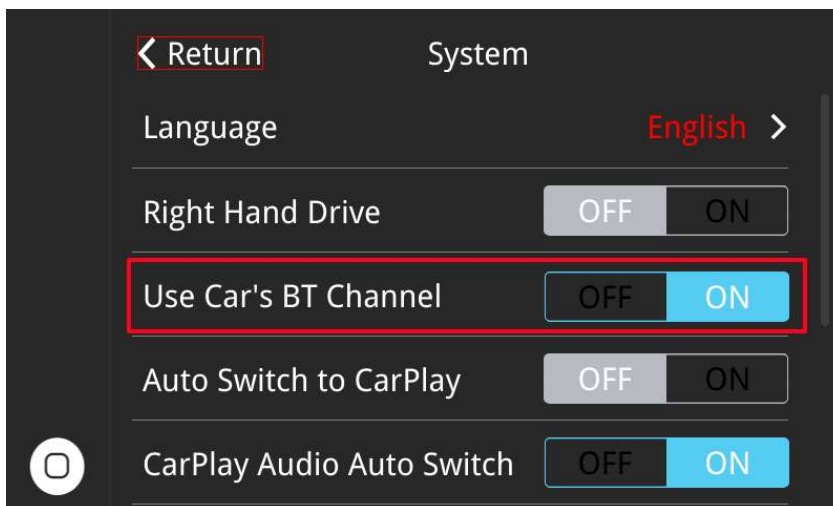

Note: This setting is only enabled when using phone Bluetooth for sound transmission.

#### 4.3.2 Pair and connect your phone Bluetooth to car OEM Bluetooth.

4.3.3 Before using the CarPlay system, you need to set the sound input on your OEM interface to "Bluetooth", then long press 'HOME" button to switch into the CarPlay system and enjoy the CarPlay.



## 5 Reverse Camera Cable Connection

### 5.1 Original camera setting

If the car has original camera, code NO.1 of toggle switch need to be set as "on".



### 5.2 Aftermarket rear camera & front view camera

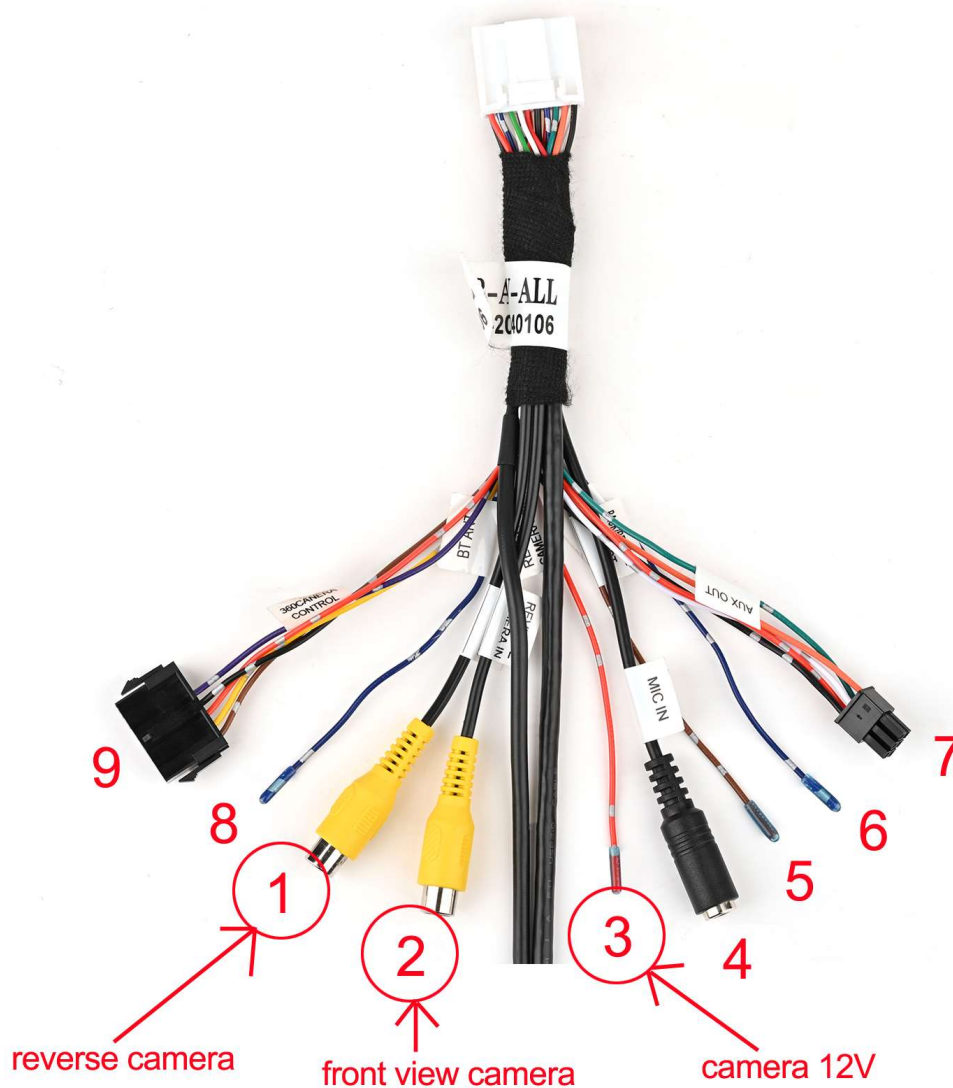



## 6 CarPlay and Android Auto

Before to use the CarPlay and Android Auto function, you need to set the CarPlay function and Android Auto function to “ON”.

Turn on Setup—Smart Phone, set Android Auto / CarPlay to “ON”

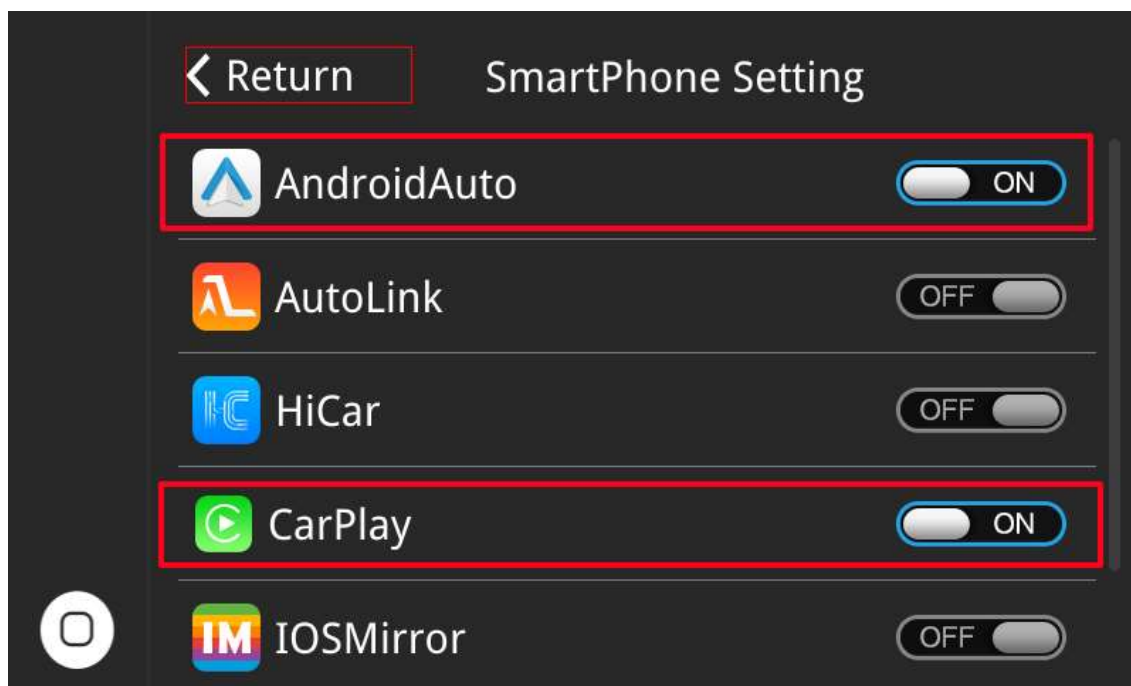

### 6.1 Wireless CarPlay / Android Auto

- 1) Disconnect or remove the Bluetooth connection between your phone and car.
- 2) Turn on your mobile Phone “Wi-Fi”.
- 3) Turn on your mobile Phone “Bluetooth”, search and pair the decoder box Bluetooth. The Bluetooth name of the decoder box is CAR-\*\*\*\*
- 4) Allow the CarPlay / Android Auto sync to your phone
- 5) Start to use CarPlay / Android Auto function.

### 6.2 Wired CarPlay / Android Auto

- 1) Connect the Product to your phone by USB cable.
- 2) Use wired CarPlay / Android Auto function.

## 7 Air Play and Mirror Link

Before to use the Mirror link function, you need to set the AutoLink function and IOS Mirror function to “ON”.

Turn on Setup—Smart Phone, set AutoLink / IOSMirror to “ON”

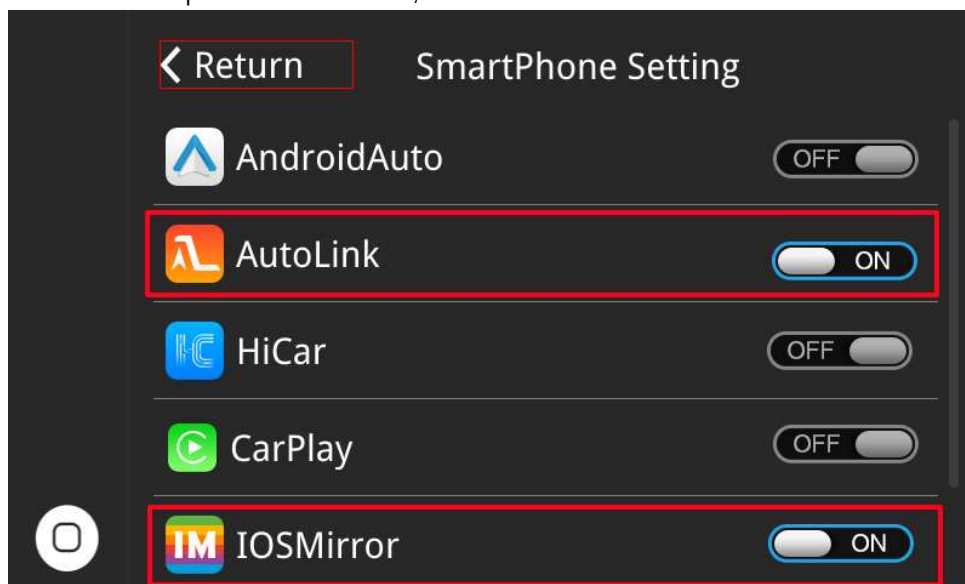

### 7.1 Wireless Air Play

- 1) Turn off the CarPlay and Turn on the IOSMirror in the Smartphone setting as show in the above picture.
- 2) Turn on your mobile Phone “WiFi”, connect your phone to the decoder box WiFi.  
The WiFi name of the decoder box is CAR-\*\*\*\*, password is 66668888
- 3) Click the AirPlay in your iPhone’s menu and start to use the AirPlay function.

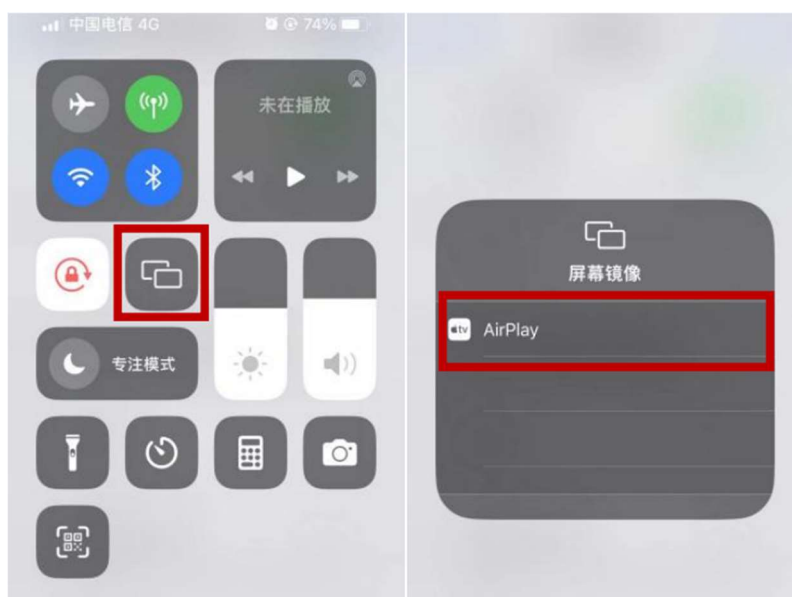

## 7.2 Wireless Android Mirroring (AutoLink)

- 1) Use your phone to scan the QR code, download and install the AutoLink APP

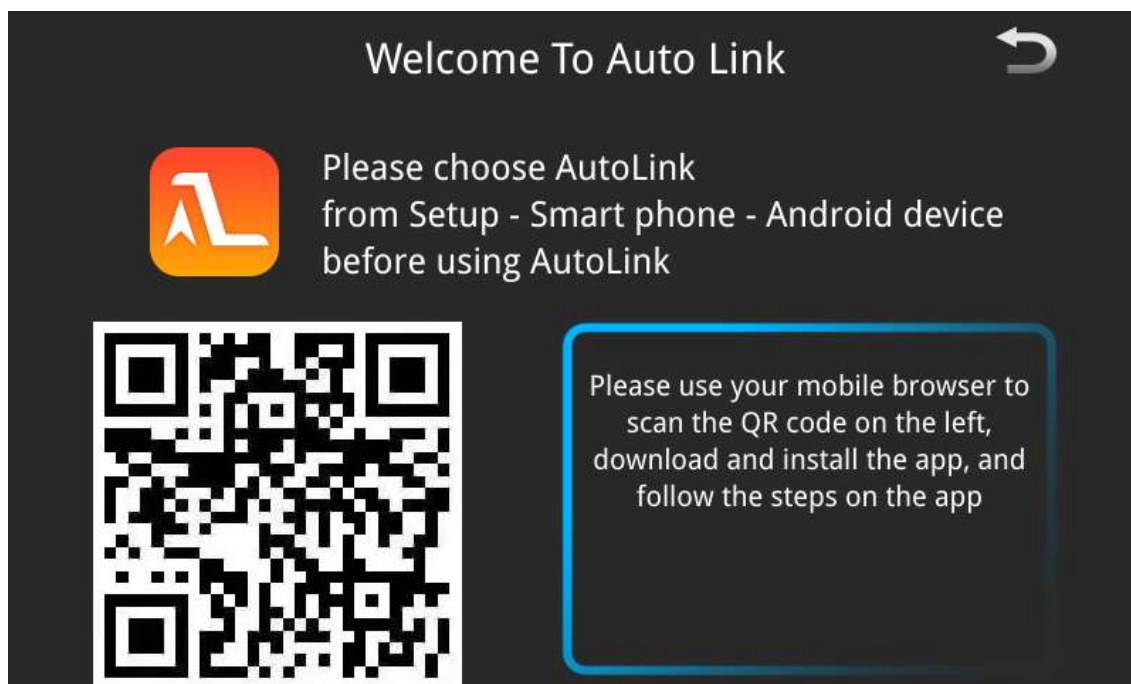

- 2) In the AutoLink APP, choose the CAR-\*\*\*\* device to start the mirror link function.

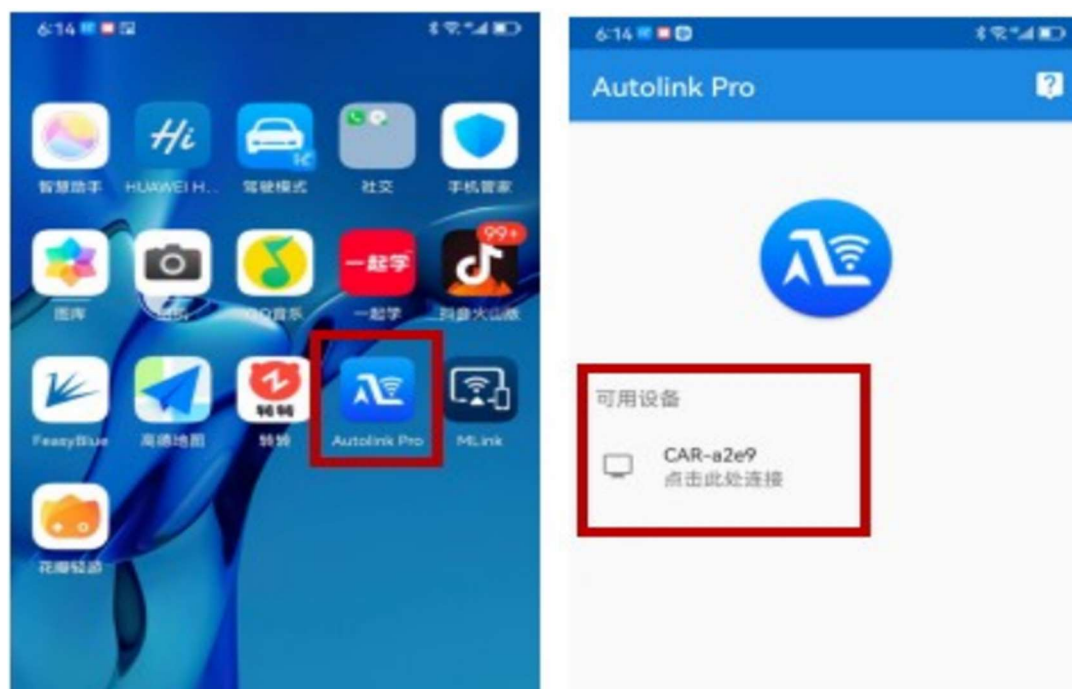

## 8 Contact Us

Please contact us via purchase platform if you need any help.

Tip: before contacting us, please help us to collect the following information.

- 1) the order ID
- 2) the car model and the year of your car
- 3) screen size of the car
- 4) the toggle switch setup
- 5) pictures about the LVDS cable connection
- 6) the software version (in the CarPlay decoder menu, Setup—System—System Version, you will see the software version.)

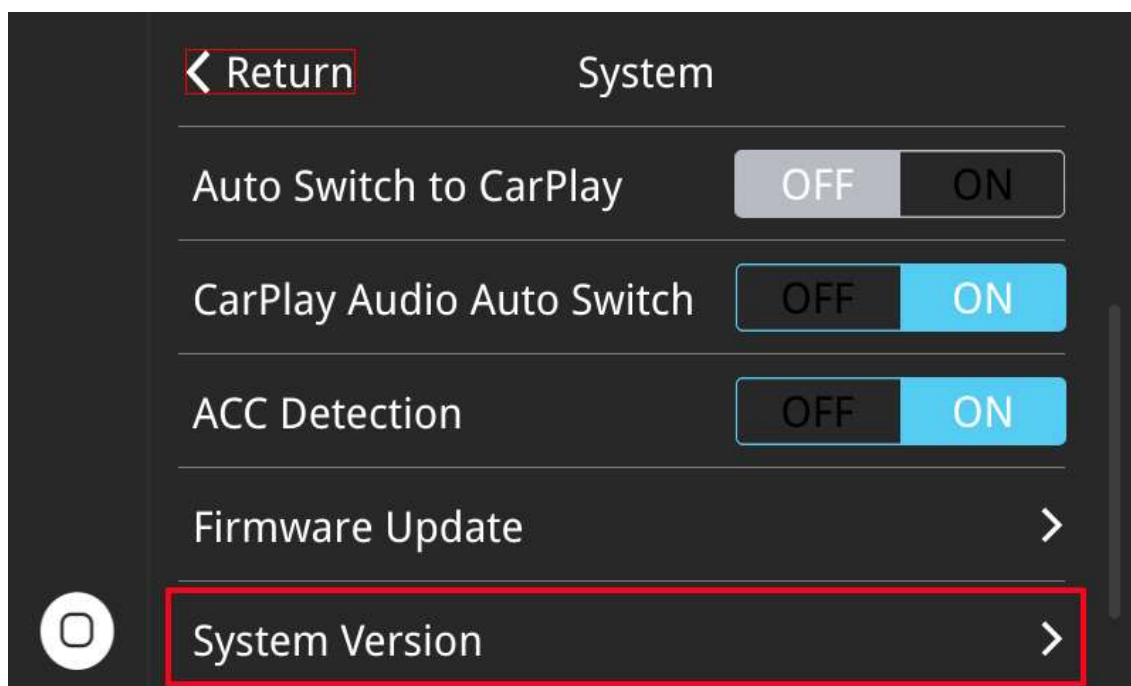

## 9 FAQ

### How to restart the device?

If any problem during use, such as unable to touch, fail to connect the device, black screen, etc., a forced reboot can be used to solve the problem. Press and hold the CarPlay switch button ("HOME" button) continuously for 10 seconds under any circumstances, and the machine will restart.